

SPeX

Hazardous Location Single Pole Plug and Receptacle



Main Advantages

- ▶ Mechanical keying system prevents intermating of phases
- ▶ Reliable mechanical and Electrical interlocking
- ▶ Automatic IP65/IP66 when plug is mated



- ▶ Features & Ratings p. 238
- ▶ SPeX p. 239
- ▶ Dimensions p. 240

Selecting the Right Hazardous Location Rated Plug and Receptacle

Hazardous Duty Product Specifications

Zone 1/21 & 2/22, Class I & II Division 2 Devices												
Product Type	Housing Material	Maximum Number of Contacts	Electrical Ratings				Certifications	Environmental Rating	Wiring Capacity		Wiring Connection	Catalog Page
			Max VAC	Amperage	Current Interruption	HP@Max Voltage			Min / Max			
DXN20	Poly	3P+N+G	600	20	YES	5	cCSAus	IP66/IP67	16 AWG	10 AWG	Screw	185
DXN30	Poly	3P+N+G + 2 aux	550	30	YES	15	cCSAus	IP66/IP67	14 AWG	6 AWG	Screw	187
DXN30	Poly	3P+N+G	600	30	YES	15	cCSAus	IP66/IP67	14 AWG	6 AWG	Screw	187
DXN60	Poly	3P+N+G	600	60	YES	20	cCSAus	IP66/IP67	10 AWG	4 AWG	Screw	189
DXN60	Poly	3P+N+G + 2 aux	550	60	YES	20	cCSAus	IP66/IP67	10 AWG	4 AWG	Screw	189
DXA1	Metal	3P+N+G	600	20	YES	5	cCSAus	IP66/IP67	16 AWG	10 AWG	Screw	195
SPeX	Poly	1P	1000	680	NO	-	cCSAus	IP65/IP66	2/0 AWG	750 MCM	Lug	239

Zone 2, Class I Division 2 Devices												
Product Type	Housing Material	Maximum Number of Contacts	Electrical Ratings				Certifications	Environmental Rating	Wiring Capacity		Wiring Connection	Catalog Page
			Max VAC	Amperage	Current Interruption	HP@Max Voltage			Min / Max			
DS20	Poly	3P+N+G + 2 aux	600	20	NO	10	cCSAus	Type 4X	14 AWG	8 AWG	Screw	199
DS30	Poly	3P+N+G + 4 aux	600	30	NO	15	cCSAus	Type 4X	14 AWG	4 AWG	Screw	201
DS60	Metal	3P+N+G + 4 aux	600	60	NO	25	cCSAus	Type 4X	10 AWG	2 AWG	Screw	203
DS100C	Metal or Poly	3P+N+G + 4 aux	600	100	NO	50	cCSAus	Type 4X	10 AWG	2 AWG	Screw	205
DSN150	Metal	3P+N+G + 6 aux	600	150	NO	75	cCSAus	Type 4X	4 AWG	2/0 AWG	Screw	207
DS200	Metal	3P+N+G + 2 aux	600	200	NO	100	cCSAus	Type 4X	4 AWG	4/0 AWG	Screw	209
DR30	Poly	3P+N+G + 2 aux	600	30	NO	-	cCSAus	Type 4X	14 AWG	8 AWG	Screw	211
DR50	Poly	3P+N+G + 4 aux	600	50	NO	-	cCSAus	Type 4X	14 AWG	4 AWG	Screw	213
DR250	Metal	3P+N+G + 2 aux	600	250	NO	-	cCSAus	Type 4X	4 AWG	4/0 AWG	Screw	215

Zone 2, Class I Division 2 Devices for Direct Current												
Product Type	Housing Material	Maximum Number of Contacts	Electrical Ratings				Certifications	Environmental Rating	Wiring Capacity		Wiring Connection	Catalog Page
			Max VDC	Amperage	Current Interruption	HP@Max Voltage			Min / Max			
DSDC1	Poly	2P+G	250	20	NO	-	cCSAus	Type 4X	14 AWG	8 AWG	Screw	217
DSDC3	Poly	2P+G	250	30	NO	-	cCSAus	Type 4X	14 AWG	4 AWG	Screw	217
DSDC6	Metal or Poly	2P+G	250	60	NO	-	cCSAus	Type 4X	10 AWG	2 AWG	Screw	217
DSDC9	Metal	2P+G	250	100	NO	-	cCSAus	Type 4X	4 AWG	2/0 AWG	Screw	217
DSDC2	Metal	2P+G	250	200	NO	-	cCSAus	Type 4X	4 AWG	4/0 AWG	Screw	217

International Configurations & Ratings												
Product Type	Housing Material	Maximum Number of Contacts	Electrical Ratings				Certifications	Environmental Rating	Wiring Capacity		Wiring Connection	Catalog Page
			Max VAC	Amperage	Current Interruption	HP@Max Voltage			Min / Max			
DXN1	Poly	3P+N+G	550	20	YES	-	ATEX, IECEx	IP66/IP67	16 AWG	10 AWG	Screw	185
DXN3	Poly	3P+N+G	750	32	YES	-	ATEX, IECEx	IP66/IP67	14 AWG	6 AWG	Screw	187
DXN3	Poly	3P+N+G + 2 aux	550	32	YES	-	ATEX, IECEx	IP66/IP67	14 AWG	6 AWG	Screw	187
DXN6	Poly	3P+N+G	750	63	YES	-	ATEX, IECEx	IP66/IP67	10 AWG	4 AWG	Screw	189
DXN6	Poly	3P+N+G + 2 aux	550	63	YES	-	ATEX, IECEx	IP66/IP67	10 AWG	4 AWG	Screw	189
DXA1	Metal	3P+N+G	600	20	YES	-	ATEX, IECEx	IP66/IP67	16 AWG	10 AWG	Screw	195
DX1	Aluminum	3P+N+G	750	20	YES	-	ATEX, IECEx	IP65	14 AWG	8 AWG	Screw	223
DX3	Aluminum	3P+N+G	750	32	YES	-	ATEX, IECEx	IP65	14 AWG	8 AWG	Screw	224
DX6	Aluminum	3P+N+G	750	63	YES	-	ATEX, IECEx	IP65/IP66	6 AWG	1/0 AWG	Screw	225
DX9	Aluminum	3P+N+G	750	125	YES	-	ATEX, IECEx	IP65/IP66	2 AWG	2/0 AWG	Screw	226
PNCX	Poly	3P+N+G	250	5	NO	-	ATEX, IECEx	IP66/IP67/IP69	20 AWG	14 AWG	Screw	229
PXN12c	Metal	11P+G	220	10	NO	-	ATEX, IECEx	IP65/IP66	16 AWG	14 AWG	Solder/Crimp	234
DXN25c	Metal	24P+G	440	10	NO	-	ATEX, IECEx	IP66/IP67	16 AWG	14 AWG	Solder/Crimp	236
DXN37c	Metal	36P+G	220	10	NO	-	ATEX, IECEx	IP66/IP67	16 AWG	14 AWG	Solder/Crimp	236
SPeX	Poly	1P	1000	680	NO	-	ATEX, IECEx	IP65/IP66	2/0 AWG	750 MCM	Lug	239

HAZARDOUS LOCATION

PRODUCT FEATURES



Hazardous location rating is based on mandatory use of pilot circuit to make and break load on phase contacts.

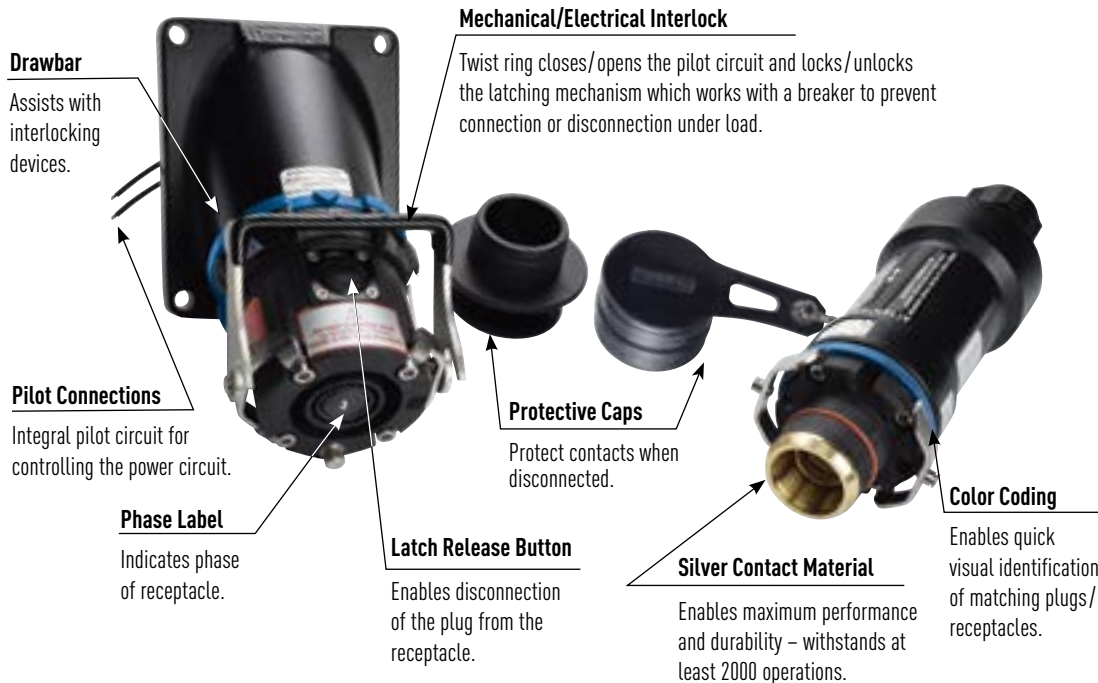

Operating Instructions



To connect, insert the plug into the receptacle until a click is heard. Rotation of the plug in either direction engages a locking finger, which prevents further rotation.



To close the pilot circuit and mechanically lock the plug into the receptacle, turn the ring on the receptacle until the "1" lines up with the arrow. This turns the power on.



To disconnect, open the pilot circuit and unlock the plug by turning the ring until the "0" is aligned with the arrow. The power is now off.



Press firmly on the latch release button and simultaneously pull on the inlet. A slight rotation of the plug may also be required.

Hazardous Location Listings (CSA or ATEX)

CSA	ATEX
Class I, Division 2, Group ABCD	II2 G D Ex e IIC T* Gb Ex IIIC T* Db IP65/IP66 Suitable for Zone 1 & 2 (gas) 21 & 22 (dust)
Class II, Division 1 Groups EFG; Class III, Division 1	
Ex e IIC; Ex tb IIIC T56°C or T76°C; IP66 (For Canada)	-20°C ≤ Ta ≤ 40°C T5 T56°C
Class I, Zone 1, AEx e IIC T5 or T6	-20°C ≤ Ta ≤ 60°C T5 T76°C
AEx tb IIIC T56°C or T76°C	-20°C ≤ Ta ≤ 40°C T6 T56°C
IP65/IP66 (For US)	-20°C ≤ Ta ≤ +60°C T4 T79°C

Amperage Ratings by Cable Size and ATEX Rating

	-20°C ≤ Ta ≤ 40°C	-20°C ≤ Ta ≤ 40°C	-20°C ≤ Ta ≤ 60°C
	G/D T5/T56°C	G/D T6/T56°C	G/D T5/T76°C
70mm ²	290 A	235 A	235 A
95mm ²	415 A	335 A	335 A
120mm ²	456 A	376 A	376 A
150mm ²	493 A	415 A	415 A
185mm ²	530 A	450 A	450 A
240mm ²	570 A	497 A	497 A
300mm ²	620 A	540 A	540 A
400mm ²	680 A	600 A	600 A

NOM ratings available upon request.

HAZARDOUS LOCATION

SPeX Hazardous Location Plugs & Receptacles

Devices rated for hazardous locations are not returnable.

cCSAus Ratings

- **Voltage**
600 VAC
- **Amperage Ratings**
600 A
- **Environmental Ratings**
IP65/IP66
- **Temperature Range**
See table page 266
- **Wiring Capacity**
Min 2/0 AWG Max 750 MCM
Aux Contacts 12-14 AWG
See table page 238
- **Applicable Standards**
CSA C22.2 No. 182.1,
CSA 213-M1987, CSA 25-1966

Plug
(Male inlet w/handle)



Receptacle on angle
(Female)



North American cCSAus Configurations

Color Code	Polarity	Part # without Lug (by cable diameter)				Part # without Lug
		.70 - .98"	.94 - 1.33"	1.33 - 1.65"	1.57 - 1.89"	
	L1	42-41001-32P	42-41001-40P	42-41001-50P	42-41001-63P	42-47001
	L2	42-41002-32P	42-41002-40P	42-41002-50P	42-41002-63P	42-47002
	L3	42-41003-32P	42-41003-40P	42-41003-50P	42-41003-63P	42-47003
	NEUTRAL	42-4100N-32P	42-4100N-40P	42-4100N-50P	42-4100N-63P	42-4700N
	GROUND	42-4100T-32P	42-4100T-40P	42-4100T-50P	42-4100T-63P	42-4700T
	POSITIVE	42-4100P-32P	42-4100P-40P	42-4100P-50P	42-4100P-63P	42-4700M
	NEGATIVE	42-4100M-32P	42-4100M-40P	42-4100M-50P	42-4100M-63P	42-4700P

IEC/CE Ratings

- **Voltage**
1000 VAC, 1500 VDC
- **Amperage Ratings**
See table page 238
- **Environmental Ratings**
IP65/IP66
- **Temperature Range**
See table page 266
- **Wiring Capacity**
Min 2/0 AWG Max 750 MCM
Aux Contacts 12-14 AWG
See table page 238
- **Applicable Standards**
ATEX, IECEx

Plug
(Male inlet w/handle)



Receptacle on angle
(Female)



IEC/CE Configurations

Color Code	Polarity	Part # without Lug (by cable diameter)				Part # without Lug
		.70 - .98"	.94 - 1.33"	1.33 - 1.65"	1.57 - 1.89"	
	L1	46-41001-32P	46-41001-40P	46-41001-50P	46-41001-63P	46-47001
	L2	46-41002-32P	46-41002-40P	46-41002-50P	46-41002-63P	46-47002
	L3	46-41003-32P	46-41003-40P	46-41003-50P	46-41003-63P	46-47003
	NEUTRAL	46-4100N-32P	46-4100N-40P	46-4100N-50P	46-4100N-63P	46-4700N
	GROUND	46-4100T-32P	46-4100T-40P	46-4100T-50P	46-4100T-63P	46-4700T
	POSITIVE	46-4100P-32P	46-4100P-40P	46-4100P-50P	46-4100P-63P	46-4700P
	NEGATIVE	46-4100M-32P	46-4100M-40P	46-4100M-50P	46-4100M-63P	46-4700M

INSTALLATION ACCESSORIES

Accessories rated for hazardous locations are not returnable.



CRIMPING LUGS

Internal Diameter		Straight w/terminal	Straight Threaded	Flexible Wiring*		Coarse Wiring	
in	mm	Part #	Part #	mm ²	AWG	mm ²	AWG
.43	11	45-4A50C	45-4A50D	50	1/0	70	2/0
.51	13.1	45-4A70C	45-4A70D	70	2/0	95	3/0
.57	14.5	45-4A95C	45-4A95D	95	3/0	120	4/0
.64	16.2	45-4A12C	45-4A12D	120	250	150	300
.71	18	45-4A15C	45-4A15D	150	300	185	400
.81	20.6	45-4A18C	45-4A18D	185	350	240	450
.91	23.1	45-4A24C	45-4A24D	240	450	300	500
1.03	26.1	45-4A30C	45-4A30D	300	600	400	750
1.15	29.2	45-4A40C	45-4A40D	400	750, 777	500	800

Notes: * Class H & I

ACCESSORIES

DRAWBAR	Part #
	45-4A376

Dimensions Inlet/Receptacle – Provided in inches

Dimensions are for reference only and may change depending on accessories used. For precise dimensions contact MELTRIC Engineering.

Inlet

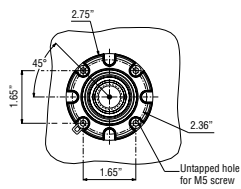

Receptacle

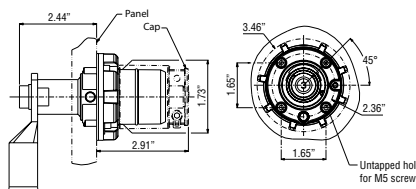

Plug

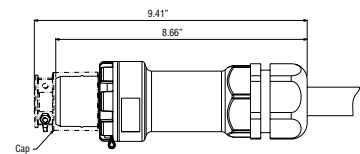

Connector

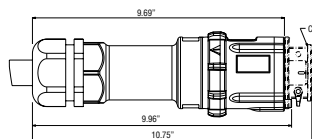

Plug/Connector

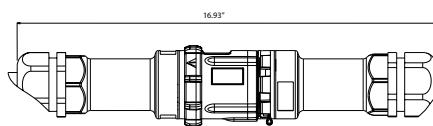

Plug with Connector On/Off

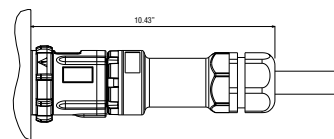

Connector with Plug On/Off

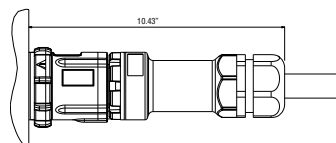

45° Inclined Receptacle/Angle with Plug

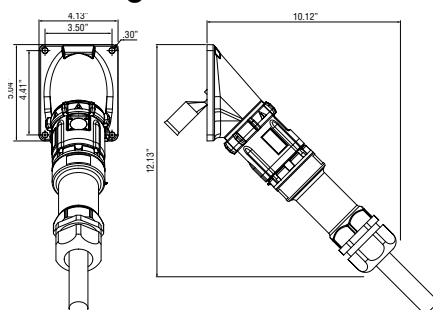

45° Inclined Inlet/Angle with Connector

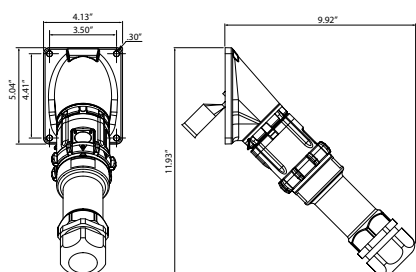

Visit meltric.com to view and download detailed SP drawing files.